

FORGE

CLEAR ICE MAKER

USE AND CARE GUIDE

CONTENTS

Safety Information	4
Consignes de Sécurité	9
Box Contents	15
Installation and Setup	16
Understanding The Forge Clear Ice Maker	17
Understanding the External Display	18
Preparing The Forge Clear Ice Maker for Use	19
Care and Cleaning	22
Operating	24
Product Specifications	27
Troubleshooting Guide	28
Warranty	33

IMPORTANT SAFETY INFORMATION

READ ALL INSTRUCTIONS BEFORE USING

▲ WARNING

To reduce the risk of fire, explosion, electric shock, or serious injury while using your Forge Clear Ice Maker, follow these basic safety precautions:

- Do not, under any circumstances, alter or remove the third (ground) prong from the power cord. For personal safety, this product must be properly grounded.
- Do not exceed power outlet ratings. It is recommended that the ice maker is connected to its own circuit. Use only a 120VAC 60 Hz standard electrical supply that is properly grounded in accordance with the National Electric Code and local codes and ordinances.
- Do not use an extension cord.
- This product must be properly installed and located in accordance with the Installation instructions before it is used.
- Do not store or use flammable vapors or liquids near this product.
- To ensure continued protection against risk of electric shock, connect to properly grounded outlets only.
- Do not allow children to use, climb on, stand on, or hang on the ice maker. They could seriously injure themselves.
- Do not use with water that is microbiologically unsafe or of

▲ WARNING CONT.

unknown quality.

- Place power cord in such a way it cannot be pulled on by children or cause a tripping hazard.
- Place power cord in such a way that it is not in contact with hot surfaces.
- Do not operate if any component, including the cord or plug, is damaged.
- Do not immerse any part of the product in water.
- Do not plug or unplug product with wet hands.
- Do not attempt to disassemble, repair, modify, or replace any part of your product. See page 33 for Warranty information.
- Use this product only for its intended purpose as described in this user manual.
- Do not use any accessories not recommended by the manufacturer.
- When handling, installing, and operating the appliance, care should be taken to avoid damage to the refrigerant tubing.
- Servicing shall be performed by factory authorized service personnel and component parts shall be replaced with manufacturer authorized replacement components.

▲ CAUTION

To reduce the risk of injury while using your Forge Clear Ice Maker, follow these basic safety precautions:

- Do not remove any safety, warning, or product information labels from your ice maker.
- Lifting Hazard: It is recommended to have two people move and install the ice maker in order to prevent injury.

▲ IMPORTANT SAFEGUARDS

When using electrical appliances, basic safety precautions should always be followed including the following:

- Read all instructions.
- To protect against electrical shock do not immerse cord, plugs in water or other liquid.
- Close supervision is necessary when any appliance is used by or near children.
- Unplug the product before cleaning by hand and when not in use.
- Do not operate any appliance with a damaged cord or plug or after the appliance malfunctions or has been damaged in any manner. Return appliance to the nearest authorized service facility for examination, repair, or adjustment.
- The use of accessory attachments not recommended by the appliance manufacturer may cause injuries.
- Do not use outdoors.
- Do not let cord hang over edge of table or counter, or touch hot surfaces.
- Do not place on or near a hot gas or electric burner, or in a heated oven.

- To disconnect, turn any control to “off”, then remove plug from wall outlet.
- Do not use appliance for other than intended use.
- Save these Instructions.

WARNING



FIRE OR EXPLOSION HAZARD Flammable Refrigerant

This appliance contains Propane refrigerant, also known as R290, a natural gas with high environmental compatibility. However, it is also combustible. Adhere to the Warnings below to reduce the risk of injury or property damage.

1. When handling, installing or operating the appliance, care should be taken to avoid damage to the refrigerant tubing.
2. Service shall be performed by factory authorized personnel. Use only manufacturer authorized service parts.
3. Dispose of appliance in accordance with Federal and Local Regulations. The flammable refrigerants and insulation material used in this product require special disposal procedures. Contact your local authorities for the environmentally safe disposal of your appliance.
4. Keep ventilation openings in the appliance enclosures clear of obstruction.
5. To remove frost, scrape with a plastic or wood spatula or scraper. Do not use an ice pick or a metal or sharp-edged instrument as it may puncture the flammable refrigerant tubing.
6. Do not use electrical appliances inside the food storage compartment of the appliance.
7. Do not use any electrical device to defrost your freezer.

Refrigerant and Foam Disposal

Dispose of appliance in accordance with Federal and Local Regulations. Flammable refrigerant and insulation material used require special disposal procedures. Contact your local authorities for the environmentally safe disposal of your appliance.

**READ, FOLLOW,
AND SAVE THESE
INSTRUCTIONS**

CONSIGNES DE SÉCURITÉ IMPORANTES

LISEZ TOUTES LES INSTRUCTIONS AVANT L'UTILISATION

▲ AVERTISSEMENT

Afin de réduire le risque d'incendie, d'explosion, de décharge électrique ou de blessure sévère lorsque vous utilisez votre machine à glaçons Forge Clear, veuillez suivre les consignes de sécurité élémentaires suivantes :

- En aucun cas, vous ne devez modifier ni retirer la troisième broche (terre) du cordon électrique. Pour votre sécurité, ce produit doit être correctement mis à la terre.
- N'excédez pas les valeurs nominales de la prise électrique. Nous recommandons que la machine à glaçon soit branchée à son propre circuit. Utilisez uniquement une alimentation électrique standard de 120 VCA, 60 Hz, correctement mise à la terre conformément au code national de l'électricité et autres codes et règlements locaux en vigueur.
- N'utilisez pas un cordon de rallonge.
- Pour vous assurer d'une protection constante contre le risque de décharge électrique, branchez l'appareil uniquement dans une prise correctement mise à la terre.

▲ AVERTISSEMENT

Afin de réduire le risque d'incendie, d'explosion, de décharge électrique ou de blessure sévère lorsque vous utilisez votre machine à glaçons Forge Clear, veuillez suivre les consignes de sécurité élémentaires suivantes :

- En aucun cas, vous ne devez modifier ni retirer la troisième broche (terre) du cordon électrique. Pour votre sécurité, ce produit doit être correctement mis à la terre.
- N'excédez pas les valeurs nominales de la prise électrique. Nous recommandons que la machine à glaçon soit branchée à son propre circuit. Utilisez uniquement une alimentation électrique standard de 120 VCA, 60 Hz, correctement mise à la terre conformément au code national de l'électricité et autres codes et règlements locaux en vigueur.
- En raison de risques potentiels pour la sécurité dans certaines conditions, nous vous mettons fortement en garde contre l'utilisation d'un cordon prolongateur. Si toutefois vous devez utiliser un cordon prolongateur, celui-ci doit présenter les caractéristiques suivantes : type pour électroménagers à trois broches avec mise à la terre, fiche avec mise à la terre, homologation UL, valeurs nominales de 15 ampères (minimum) et 120 volts.
- Pour vous assurer d'une protection constante contre le risque de décharge électrique, branchez l'appareil uniquement dans une prise correctement mise à la terre.
- Ce produit doit être installé correctement et placé conformément aux instructions d'installation avant son utilisation.
- Ne rangez ni n'utilisez des vapeurs ou liquides inflammables à proximité de ce produit.
- Ne permettez pas aux enfants d'utiliser la machine à glaçons, ni de grimper, se tenir ou s'accrocher sur celles-ci. Ils pourraient se blesser gravement.
- N'utilisez pas d'eau de qualité douteuse ou qui n'est pas sûre sur le plan microbiologique.
- Placez le cordon électrique de façon qu'il ne soit pas tiré par les enfants ni qu'il pose un risque de trébuchement.

▲ AVERTISSEMENT (suite)

- Placez le cordon électrique de façon qu'il ne touche pas aux surfaces chaudes.
- Ne faites pas fonctionner l'appareil si l'un de ses composants, cordon ou fiche inclus, est endommagé.
- N'immergez aucune pièce de ce produit dans l'eau.
- Ne branchez ni ne débranchez le produit avec les mains mouillées.
- Ne tentez pas de démonter, réparer, modifier ou remplacer une pièce quelconque de ce produit. Voyez la page 33 pour des renseignements sur la garantie.
- Utilisez ce produit uniquement aux fins auxquelles il est destiné qui sont décrites dans ce manuel d'utilisation.
- N'utilisez aucun accessoire qui n'est pas recommandé par le fabricant.
- Lors de la manipulation, de l'installation et de l'utilisation de cet appareil, prenez soin de ne pas endommager la tubulure du réfrigérant.
- Les réparations doivent être effectuées par du personnel de service autorisé par l'usine et les pièces remplacées par des exemplaires autorisés par le fabricant.

▲ ATTENTION

Pour réduire le risqué de blessure lors de l'utilisation de votre machine à glaçons Forge Clear, observez les consignes de sécurité élémentaires suivantes:

- Ne retirez aucune étiquette apposée sur la machine à glaçons qui présente des renseignements sur la sécurité, les avertissements ou le produit.
- Risque associé à une charge lourde : Nous recommandons que deux personnes déplacent et installent la machine à glaçons afin de prévenir les blessures.

MESURES DE SECURITE IMPORTANTES

L'utilisation d'appareils électriques exige d'observer des précautions élémentaires, dont les suivantes :

- Lisez toutes les instructions.
- Afin de vous protéger contre les décharges électriques, n'immergez pas le cordon ni les fiches dans l'eau ou d'autres liquides.
- Une surveillance étroite est requise lorsque cet appareil est utilisé par des enfants ou à proximité de ceux-ci.
- Débranchez le produit avant de le nettoyer à la main ou lorsqu'il n'est pas utilisé.
- N'utilisez aucun appareil dont le cordon ou la fiche sont endommagés ni s'il a subi une défectuosité ou un autre dommage. Retournez l'appareil auprès du centre de service autorisé le plus près pour inspection, réparation ou réglage.
- L'utilisation d'accessoires non recommandés par le fabricant peut occasionner des blessures.
- N'utilisez pas l'appareil à l'extérieur.
- Ne laissez pas le cordon pendre par-dessus le bord d'une table ou du comptoir, ni toucher des surfaces chaudes.
- Ne placez pas l'appareil sur ou près d'un four chaud ni d'un brûleur électrique ou à gaz chauds.
- Pour débrancher, mettez toutes les commandes à OFF (arrêt), puis retirez la fiche de la prise murale.
- N'utilisez pas l'appareil à des fins différentes de celles prévues.
- Conservez ces instructions.

AVERTISSEMENT

 **RISQUE D'INCENDIE OU D'EXPLOSION** Fluide frigorigène inflammable

Cet électroménager contient le réfrigérant propane, aussi connu comme R290, un gaz naturel à compatibilité élevée avec l'environnement. Il s'agit cependant d'un combustible. Observez les consignes de sécurité ci-dessous afin de réduire le risque de blessure ou de dommage à la propriété.

1. Lors de la manipulation, de l'installation et de l'utilisation de cet appareil, prenez soin de ne pas endommager les tubes de circulation du fluide frigorigène.
2. L'entretien ou la réparation doivent être effectués par un personnel de service autorisé. Utilisez seulement des pièces de rechange autorisées par le fabricant.
3. Mettez l'appareil au rebut conformément aux réglementations fédérales et locales. Le fluide frigorigène inflammable et le matériel isolant utilisés nécessitent des procédures de mise au rebut spéciales. Communiquez avec les autorités locales compétentes pour la mise au rebut de votre réfrigérateur sans danger pour l'environnement. Keep ventilation openings in the appliance enclosures clear of obstruction.
4. N'obstruez pas les événements dans l'enceinte prévue pour l'appareil. Do not use electrical appliances inside the food storage compartment of the appliance.
5. Pour retirer le givre, grattez à l'aide d'un grattoir ou d'une spatule en plastique ou en bois. N'utilisez pas un pic à glace ni un instrument métallique ou aux arêtes coupantes car il y a risque de percer la doublure du congélateur et la tubulure du réfrigérant inflammable derrière elle.
6. N'utilisez pas d'appareils électriques dans le compartiment réfrigérateur de cet appareil.
7. N'utilisez aucun appareil électrique pour dégivrer votre congélateur.

Élimination du réfrigérant et de la mousse

Jeter l'appareil conformément aux réglementations fédérales et locales. Le réfrigérant inflammable et les matériaux d'isolation utilisés nécessitent des procédures d'élimination spéciales. Contactez vos autorités locales pour l'élimination écologique de votre appareil.

**LISEZ, SUIVRE, ET
CONSERVER CES
INSTRUCTIONS**

WHAT'S INCLUDED



x1 Forge Clear Ice Maker

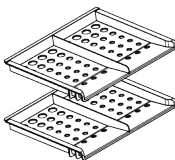

x2 Ice Shelves



x1 Quick Start Guide

INSTALLATION REQUIREMENTS

CAUTION

Lifting Hazard: It is recommended to have two people move and install the ice maker in order to prevent injury.

To ensure continued protection against risk of electric shock, connect to properly grounded outlets only.

ATTENTION

Risque lié à la manipulation d'un objet lourd : Nous recommandons que deux personnes déplacent et installent la machine à glaçons afin de prévenir les blessures.

Afin d'assurer une protection continue contre le risque de décharge électrique, branchez l'appareil dans des prises correctement mises à la terre seulement.

- Product is designed to be installed indoors. Do not use your ice maker outdoors.
- Product must be installed upright on a flat, level surface that is able to support the total weight when full of water.
- Ensure a minimum of three inch (3") clearance around each side and one inch (1") clearance in the back of the ice maker for proper air circulation.
- Install the product in a well-ventilated area with an ambient temperature between 55°F and 90°F.
- Do not place the product near heat sources such as ovens or cooktops.
- Do not place the product in direct sunlight.
- Do not place directly under intense countertop lighting.
- Intended for household use only.
- Do not immerse in water.

UNDERSTANDING THE FORGE CLEAR ICE MAKER

The Forge Clear Ice Maker communicates through both a light bar underneath the door and on-screen messaging.

On-screen message	Meaning
Ice Making Off	Forge is holding previously made ice in a tempered state. To make ice, press the “Ice Making On/Off” button.
Ice Making On	Forge is actively making ice gems while holding previously made ice gems in a tempered state.
Ice Chute Full	Forge’s bottom ice shelf is full. To make more ice, move ice gems from the bottom of ice maker to the top storage shelf, or fully remove the ice gems from the ice maker.
Water Low	To continue making ice, fill the reservoir with water.
Cleaning Recommended	When Forge needs to be cleaned, the display will cycle between “Cleaning Recommended” and the current ice making mode. Press and hold “Activate Cleaning Cycle” button to begin cleaning cycle.
Clean Cycle Activated	Once the cleaning cycle is activated, follow the on-screen prompts to complete the cleaning process

UNDERSTANDING THE EXTERNAL DISPLAY

When Forge's door is closed, the ice maker communicates by displaying different light colors and patterns at the base of the door.

External lighting	Meaning
No Light	Ice Making Off. Forge is holding ice in a tempered state when plugged in. To make ice, press the "Ice Making On/Off" button.
Solid White	Ice Making On. Forge is actively making ice gems while holding previously made ice gems in a tempered state.
Pulsing Blue	Water Low. To continue making ice, fill the reservoir with water.
Solid Yellow	Clean Cycle Activated. Forge is working through the automated portion of its cleaning cycle.
Pulsing Yellow	User action required. Follow the on-screen prompts to complete the cleaning process.

PREPARING THE FORGE CLEAR ICE MAKER FOR USE

⚠ WARNING

Chemical Exposure Hazard: If cleaning with bleach, use bleach in a well ventilated area and avoid mixing bleach with other household cleaners.

⚠ AVERTISSEMENT

Risque d'exposition à des produits chimiques : Si vous nettoyez avec un javellisant, travaillez dans un endroit bien ventilé et évitez de mélanger le javellisant avec d'autres nettoyants domestiques.

⚠ ATTENTION

Some types of under-cabinet lamps can be hot enough to cause damage to your Ice Maker's appearance.

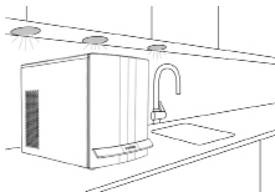

⚠ ATTENTION

Certains types de lampes sous armoire peuvent devenir suffisamment chauds pour endommager l'apparence de votre machine à glaçons.

1. Carefully remove packing material. Do not use sharp tools that can damage the ice maker.
2. Ensure all components are present. If any item is missing, please contact **Forge@FirstBuild.com**.
3. Place the ice maker upright on a flat, level surface and plug it in.
- 4. Sanitize the ice maker before first use, following these steps.**
5. Press and hold the “Activate Clean Cycle” button for 3 seconds to begin cleaning cycle. See Fig. 1.
6. Remove the lower ice shelf, and fill the ice maker with clean water up to the maximum fill line (marked on the inside of the reservoir). Replace lower ice shelf. See Fig. 2.
7. Add 4 tsp of household bleach to the reservoir full of water and stir to mix.
8. Dip a disposable cloth into the solution and wipe down the interior surfaces of the ice maker

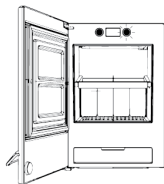

Fig. 1, press and hold “Activate Clean Cycle” button.

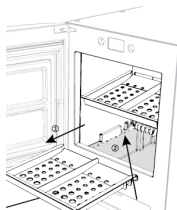

Fig. 2, remove lower shelf and fill reservoir with clean water to the fill line.

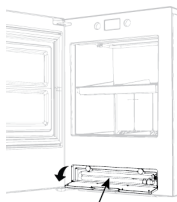

Fig. 3, drain the reservoir using the front drain tube.

9. Press “Activate Clean Cycle” button to continue. The light bar on the bottom of the door will switch to yellow, signaling cleaning mode is active.
10. When the light bar begins to pulse yellow, action is required. Follow the on-screen prompts.
11. Once cleaning is completed, drain the reservoir using the front drain tube. See Fig. 3. Remove and discard any ice in the ice maker. Do not consume this ice.
12. Fill with fresh water. Press the “Activate Clean Cycle” button to continue to rinse cycle.
13. When the light begins to pulse yellow, action is required. Follow the on-screen prompts.
14. Complete one more rinse cycle. Fill with fresh water. Press the “Activate Clean Button” to continue to rinse cycle.
15. Once the rinse cycle has been completed, dip a disposable cloth into the clean water and wipe down the interior surfaces of the ice maker.
16. Drain the reservoir using the front drain tube and press “Activate Clean Cycle” button to end the cycle.

Your Forge Clear Ice Maker is now ready for use.

CARE AND CLEANING

Exterior Cleaning

To clean the **exterior** of the Forge Clear Ice Maker, use a soft cloth dampened with soapy water to gently clean the exterior surfaces. Dry with a soft cloth.

Do not use appliance wax, polish, solvents, or chemicals.

Interior Cleaning

Keep your ice clear and tasting fresh by cleaning your Forge Clear Ice Maker every 12 cycles (every 24 ice gems created). The automated portion of the cleaning cycle takes approximately one hour, with total active time from the user requiring approximately 10 minutes throughout.

To clean the internal components of your Forge Clear Ice Maker, follow the steps below. You will be assisted by on-screen prompts.

1. Plug the ice maker in.
2. Use the front drain tube to empty all water from ice maker. See Fig. 4 on next page.
3. Remove and discard any ice from ice maker.
4. Press and hold the “Activate Clean Cycle” button for 3 seconds to begin cleaning cycle. See Fig. 5 on next page.
5. Fill the ice maker reservoir with clean water up to the maximum fill line, and add an entire bottle of Forge Cleaning Solution into the reservoir, to mix with the clean water. See Fig. 6 on next page.
6. Press “Activate Clean Cycle” button to continue.
7. Dip a sponge into the reservoir filled with water and Forge Cleaning Solution mixture and scrub gently to remove calcium or other deposits from interior surfaces. Inspect the filter in the back of the reservoir for any particulates needing removal, and scrub gently.

8. Press “Activate Clean Cycle” button to continue. The light bar on the bottom of the door will switch to yellow, signaling cleaning mode is active.
9. When the light bar begins to pulse yellow, action is required. Follow the on-screen prompts.
10. Once cleaning is completed, drain the reservoir using the front drain tube. Remove and discard any ice in the ice maker. Do not consume this ice.
11. Fill with fresh water. Press the “Activate Clean Cycle” button to continue to rinse cycle.
12. When the light begins to pulse yellow, action is required. Follow the on-screen prompts.
13. Complete one more rinse cycle. Fill with fresh water. Press the “Activate Clean Cycle” button to continue to rinse cycle.
14. Once rinse cycle has been completed twice, drain the reservoir and press “Activate Clean Cycle” button to end the cycle. Drain the reservoir.

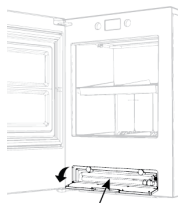

Fig. 4, drain the reservoir using the front drain tube.

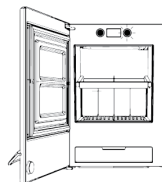

Fig. 5, press and hold “Activate Clean Cycle” button.

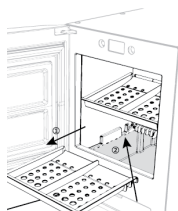

Fig. 6, remove lower shelf and fill reservoir with clean water to the fill line.

OPERATING THE FORGE CLEAR ICE MAKER

Making Ice

Once your Forge Clear Ice Maker has been cleaned, follow the steps below to begin making clear ice.

1. Fill reservoir with potable (safe to drink) water up to the “Fill” line. Water hardness must be less than 12 grains per gallon (205 ppm). **Do not fill reservoir with any liquid except water. Using any liquid except potable water is misuse and will void your warranty.**
2. Plug the ice maker into a grounded outlet.
3. Press the “Ice Making On/Off” button to start making ice. The light display strip will display solid white light and the text display will show “Ice Making On”.
4. Use ice stored on Forge’s top shelf shortly after moved, or keep on the bottom shelf for longer-term storage.
5. Forge will produce a pair of ice gems approximately every 4 hours, depending on the initial water temperature and ambient temperature. Forge will continue to make ice until the bottom shelf is full (4 gems), or until it runs out of water. To continue making ice, simply move the ice gems from the bottom ice shelf up to the top storage shelf or to a secondary freezer, and add more water. For best results, ice gems stored on Forge’s top shelf should be used within a few days.

Draining Water

The Forge Clear Ice Maker should be drained completely after the creation of approximately 24 ice gems. It is also recommended to drain Forge's reservoir when not in use. To drain the Forge Clear Ice Maker:

1. Use the front drain tube to empty all water from the ice maker. (See Fig. 3 on page 20.)
2. Reinstall the drain tube at the front of the ice maker to its original position.
3. Refill the ice maker reservoir with clean water up to the maximum fill line.

Normal Sounds

Your new ice maker may make sounds that are not familiar. Most of these sounds are normal. Hard surfaces like the floor, walls, and countertops can amplify these sounds. The following describes the sounds that may be new to you and what may be creating them.

WHIR	When Forge Clear Ice Maker is first turned on, you may notice the condenser fan spinning.
BUZZ	When the water pump first turns on, it may be dry and slightly noisy. Once it is filled with water, the noise reduces significantly.
RATTLE	Rattling noises may be produced from the flow of the refrigerant. These noises should reduce significantly once the refrigerant system has stabilized.
GURGLE	When the refrigerant system shuts off, there may be a brief gurgle as the refrigerant stops flowing.
HUM	The compressor is a motor. It produces a low toned humming sound while it is running.
THUD	As clear ice gems are produced, they drop into the ice shelf. This impact creates a muffled, yet audible noise.

PRODUCT SPECIFICATIONS

The technical data and performance data below is provided for reference only. Specifications are subject to change. Check the rating label on your product for the most up-to-date information.

Description	Countertop Clear Ice Maker
Model	FORGE01
Color	Black
Product Weight (when empty)	Approximately 50 lbs
Exterior Dimensions	16.5" tall, 11.6" wide, 23.6" deep
Installation Clearance (sides & rear)	3" Sides, 1" Back
Nominal Operating Voltage/Frequency	120VAC/60Hz
Current	2A
Ambient Operating Temperature	55-90°F
Ice Storage Capacity	8 Clear Ice Gems
Ice Production Rate	2 Clear Ice Gems approx. every 4 hours*

**The actual rate of ice production varies with environmental conditions and Ice Gem size settings.*

TROUBLESHOOTING GUIDE

Possible solutions are subject to change. See the FAQ section at ForgeClearIce.com for the most up-to-date information.

Why is my ice cloudy, misshapen, or hollow?

- Forge may not be properly cleaned. Clean interior of the ice maker as outlined on page 22 of this manual.
- You may need to clean Forge's two nozzles, which are located behind the doors behind the lower ice shelf. To access the nozzles, remove the ice shelves. See Fig. 7 on page 29. Lift the flaps behind the lower shelf, and feel for the two nozzles. Twist counterclockwise to release and remove. Once removed, clean thoroughly using soapy water or vinegar. Inspect and remove anything that may be clogging the nozzle. Rinse thoroughly and reinstall. Ensure the nozzles are installed properly.
- Forge's Clear Ice Gems don't need to be perfectly flat to create a beautiful sphere in the Forge Ice Press. Occasionally, however, you may need to increase the size of your ice gems. See page 31 for instructions.
- Forge may not have enough clearance on sides. Ensure there is at least 3 inches of clearance on each side, and 1 inch clearance in the back.
- Forge may not have sufficient water in the reservoir. Fill the reservoir.
- As ice is fragile, you may occasionally see a cracked ice gem. If you are seeing cracked ice more than occasionally, activate a cleaning cycle.

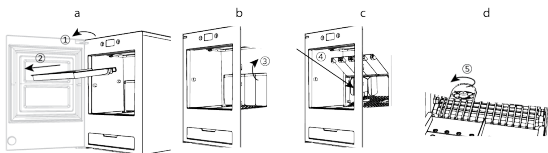

Fig. 7, (a) Open the ice maker door and remove the ice shelves. (b) Lift the flaps behind the lower shelf, (c) and feel for the two nozzles. Twist counterclockwise to release and remove.

Why does the ice shelf area of Forge seem warm?

- Forge may be placed in an area that's too warm. Ensure Forge is installed in a location with an ambient temperature between 55°F and 90°F. Do not install in an area with a temperature above 90°F.
- Forge may not be in a well-ventilated area. If installed in cabinetry, remove for proper ventilation.
- Forge may not have enough clearance on sides. Ensure there is at least 3 inches of clearance on each side and 1 inch of clearance in the back.
- Forge's door may be slightly open. Ensure the door is closed and sealed.
- The water inside the reservoir may be too warm. Ensure the water is cool enough for proper ice gem making. Do not use hot water.

<p>Why is there an odor?</p>	<ul style="list-style-type: none"> • If the filled reservoir is left standing for an extended period of time without activity, the water may need to be refreshed. Drain and clean the interior of Forge as outlined on page 22 of this manual, and leave the door open to dry. • Forge may not be properly cleaned. Clean interior of the ice maker as outlined on page 22 of this manual. • If Forge has already been cleaned and the odor persists, you may need to perform a rinse. To do this, complete a cleaning cycle using only fresh water and no cleaning solution.
<p>Why is ice being made slower than normal?</p>	<ul style="list-style-type: none"> • Forge may be placed in an area that's too warm. Ensure Forge is installed in an area with an ambient temperature between 55°F and 90°F. Do not install in an area with a temperature greater than 90°F. • The water inside the reservoir may be too warm. Ensure the water is cool enough for proper ice gem making. Do not use hot water. Use cold water for faster ice creation. • Forge's door may be slightly open. Ensure the door is closed and sealed.

<p>Why will my ice maker not run?</p>	<ul style="list-style-type: none"> • Forge may be turned off. Ensure the ice maker is turned on. • There may be a tripped breaker. Ensure Forge has not tripped a breaker. • Forge may have used all the water in the reservoir or the water supply is low. Ensure the reservoir is filled with potable water. • Forge’s door may be slightly open. Ensure the door is closed and sealed. • Forge may be plugged into an outlet with too many other products. Ensure Forge is in a grounded outlet and it is able to draw enough power to run efficiently.
<p>How can I adjust the size of my ice gems?</p>	<ul style="list-style-type: none"> • To change the size of your gems: 1. Press and hold “Ice Making On/Off” and “Activate Cleaning Cycle” buttons at the same time. The display screen will then display a scale of 1-7, with 1 being the smallest and 7 being the largest gem size. (The default ice gem is a size 4.) 2. Cycle through the size scale by selecting the “Activate Clean Cycle” button. 3. Once your desired gem size is determined, press and hold both buttons to select and exit. Note that increasing the size of the ice gems will also increase the time it takes Forge to make ice. • Changing the size of your ice gems is only possible when Forge is not in ice making mode.

<p>Why do I see drops of water on Forge?</p>	<ul style="list-style-type: none"> • Some condensation is normal in high-humidity environments. • Forge may be placed in an area that's too warm. Ensure Forge is installed in an area with an ambient temperature between 55°F and 90°F. Do not install in an area with a temperature above 90°F. • Forge may not be in a well-ventilated area. If installed in cabinetry, remove for proper ventilation. • Forge may not have enough clearance on sides. Ensure there is at least 3 inches of clearance on each side and 1 inch of clearance in the back. • Forge's door may be slightly open. Ensure the door is closed and sealed. • Ensure the drain tube door on the front of Forge is connected and closed.
<p>Why am I seeing frost?</p>	<ul style="list-style-type: none"> • It is normal to see a slight frosting of Forge's interior. • If Forge's Ice Gems appear frosty, place them in a bowl and leave at room temperature for approximately five minutes. The frost will clear on its own and the ice will regain its clarity.
<p>Why do my Ice Gems appear smaller over time?</p>	<ul style="list-style-type: none"> • Over time, Forge's Ice Gems will naturally undergo sublimation. As heat rises, you may also notice this happening more noticeably on any ice held on the top shelf. Any meltwater from Forge Ice Gems will be recycled back into the lower reservoir.

LIMITED MANUFACTURER'S WARRANTY

Limited Warranty Period

The Limited Warranty period is one (1) year from the date of receipt of the product. Unless the purchaser proves otherwise, the receipt date will be assumed to be the purchase date.

What is Covered

Product failure during the Limited Warranty period due to a defect in materials or workmanship.

What is Not Covered

- Product failure due to abuse, misuse, or improper use.
- Damage to the product caused by accident, fire, floods, or acts of God.
- Incidental or consequential damages caused by possible defects with this product. *
- Labor and other charges to install and/or remove the product.
- Product used for commercial purposes and/or other than in a residential home.

** Some states do not allow the exclusion or limitation of incidental or consequential damages. This warranty gives you specific legal rights, and you may also have other rights which vary from state to state. To determine what your legal rights are, consult your local or state consumer affairs office or your state's Attorney General.*

What FirstBuild Will Do

If your product qualifies for this Limited Warranty, FirstBuild will either: (1) replace your product with a new or remanufactured product, (2) refund the purchase price of the product, or (3) repair the product at FirstBuild's sole discretion.

Limitations

The Limited Warranty is provided to the original purchaser for products purchased for residential use within the United States.

How to File a Warranty Claim

All warranty claims must be initiated through an e-mail to Forge@FirstBuild.com. When initiating a claim, please provide your first and last name, shipping address, phone number and proof of purchase. FirstBuild will respond to your inquiry and give you further instructions on how to handle your claim. No return shipments will be accepted until they are authorized by a representative of FirstBuild. All return shipments should be sent to FirstBuild c/o Warranty Claims Dept., 333 East Brandeis Avenue, Louisville, KY, 40208.

EXCLUSION OF IMPLIED WARRANTIES: Your sole and exclusive remedies are product exchange or refund as provided in this Limited Warranty. Any implied warranties, including the implied warranties of merchantability or fitness for a particular purpose, are limited to six (6) months or the shortest period allowed by law.

